



HARDSCRABBLE
ROAD EXTENSION

The Heritage at Roswell Condos and Thms

S.R. 92

FILE: ATLAS 97
REVISED: 07.21.10
SCALE: NONE
DATE: 2/21/01
DRAWN: S.HAMBY

City of Roswell Engineering Division

38 HILL ST. STE. G-30 ROSWELL, GA. 30075
PH. # 770-641-3780 FAX. # 770-641-3741

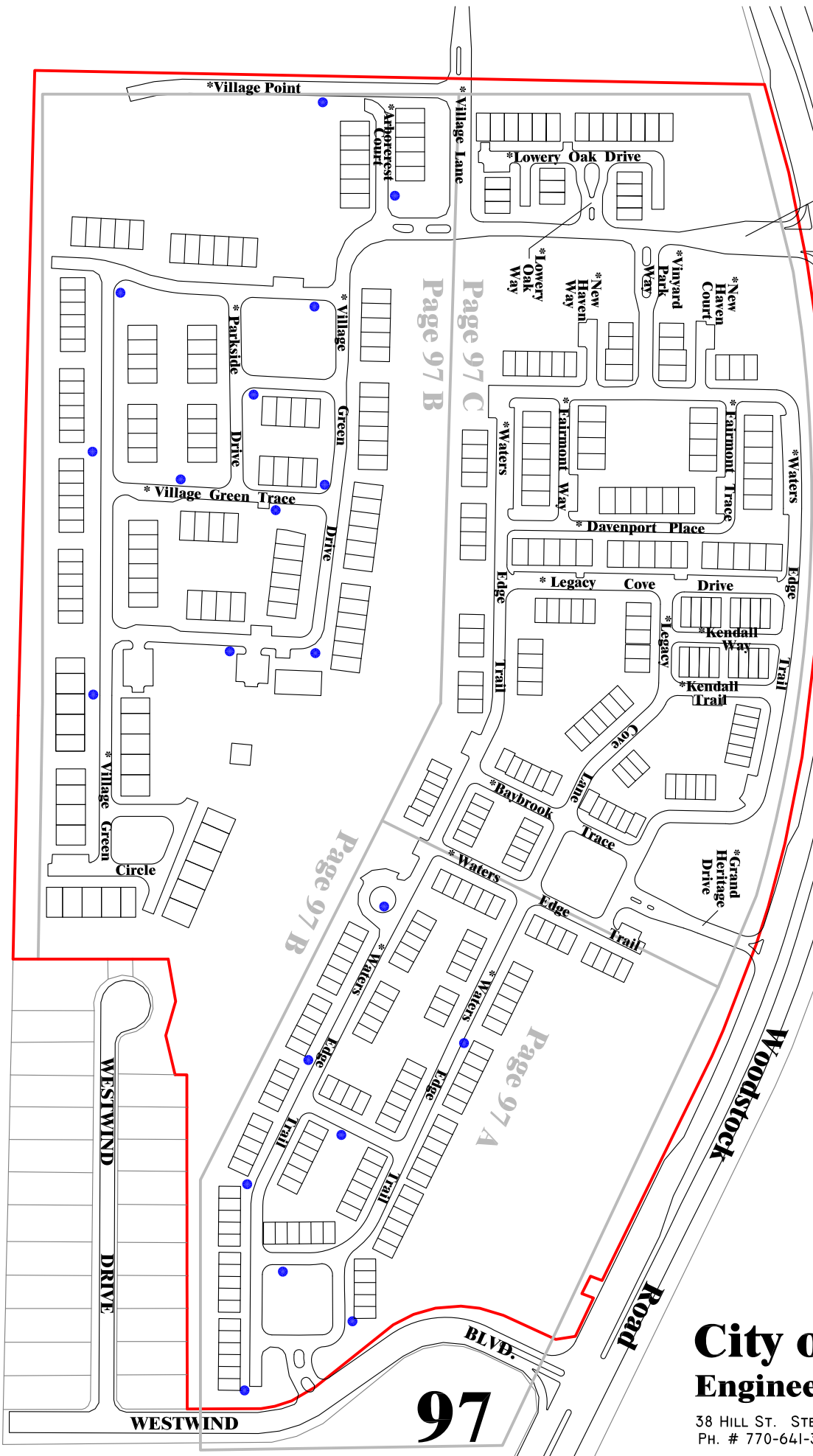

Page 97 C

Page 97 B

Page 97 A

97