

SLOAN STREET

MILL STREET

Founders Mill Townhomes

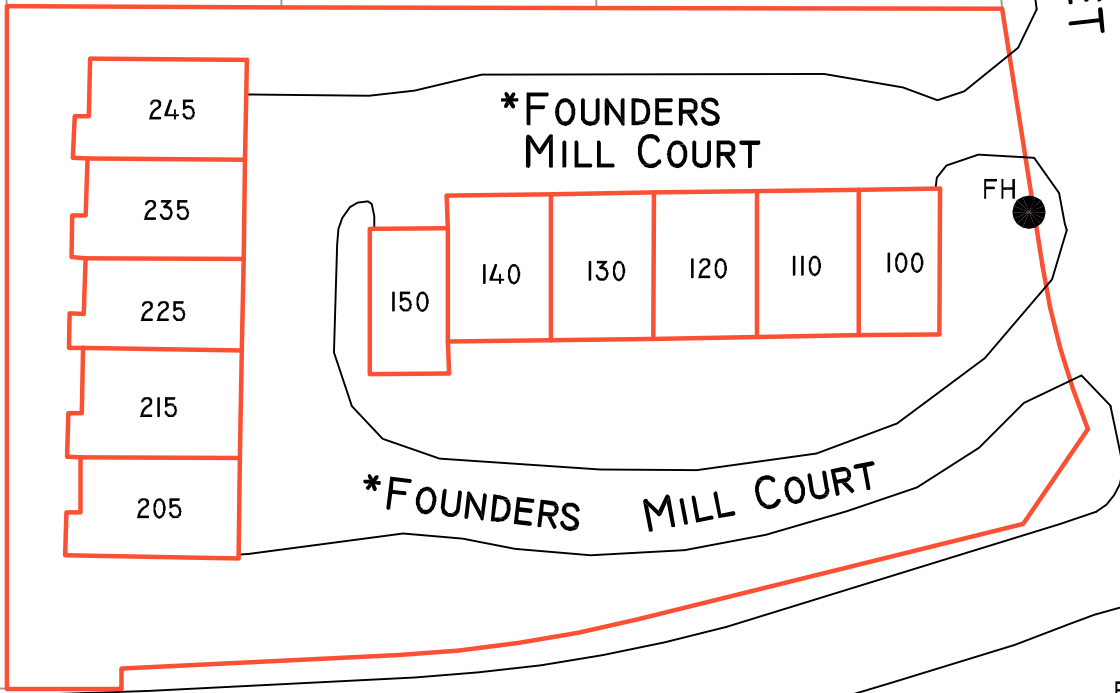

MILL STREET

City of Roswell Engineering Division

38 HILL ST. STE. G-30 ROSWELL, GA. 30075
PH. # 770-641-3780 FAX. # 770-641-3741

111

SCALE: NONE FILE: ATLAS III
DATE: 04/23/03 REVISION: 03/29/04
DRAWN: S. HAMBY